

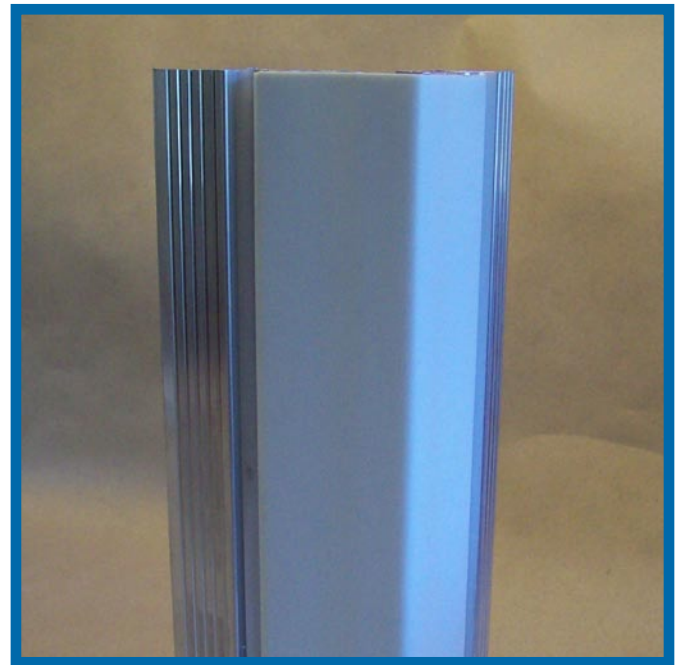

Flush Mount Corner Guard

Models CG2-F (shown), CG3-F, CG135-F

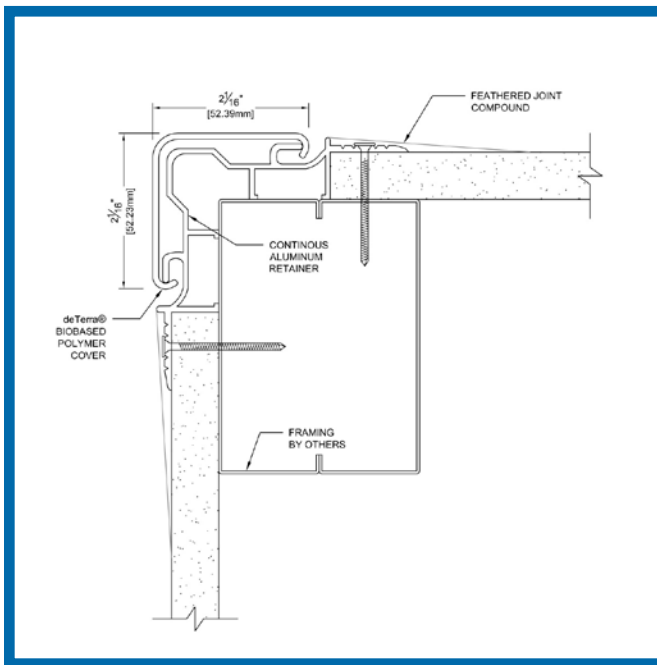

Flush mount corner guards provided a clean, finished look. Intended for use in new construction, they are available in custom heights up to 12'0 (3658mm) for floor-to-ceiling protection. Install aluminum retainers when the wall is built, then finish with snap-on covers made from deTerra® biobased polymer. Available in 2" (50.8mm) and 3" (76.2mm) guards are available in 90 degree corners and 3" (76.2mm) for 135 degree corners.

About Alpar Architectural Products

Alpar Architectural Products LLC provides impact protection for walls with the least possible environmental impact. All of our products are FREE from polyvinylchloride (PVC), petroleum and persistent bioaccumulative toxins (PBTs) and are made from recycled and rapidly renewable materials including deTerra® biobased polymer, aluminum and stainless steel.

DeTerra® biobased polymer looks and feels like traditional plastics but is made from nearly 90% rapidly renewable materials and are grown and processed into compound within 500 miles of our plant. It is the only wall protection material that is approved by the EPA as biodegradable and that can be composted. It is Class 1/A fire rated and far outperforms PVC, PETG and ABS for flame spread and smoke density when tested to ASTM E84. It also outperforms these materials in many mechanical, chemical and stain resistance tests relevant to wall protection.

Alpar Architectural Products is a woman-owned business enterprise (WBE).

Alpar Architectural Products LLC
877-721-0156
612-721-0156
Fax 612-395-9183
info@alpararch.com
www.alpararch.com

© Copyright 2011 Alpar Architectural Products, LLC.
DeTerra is a registered trademark of Interfacial Solutions IP, LLC.