

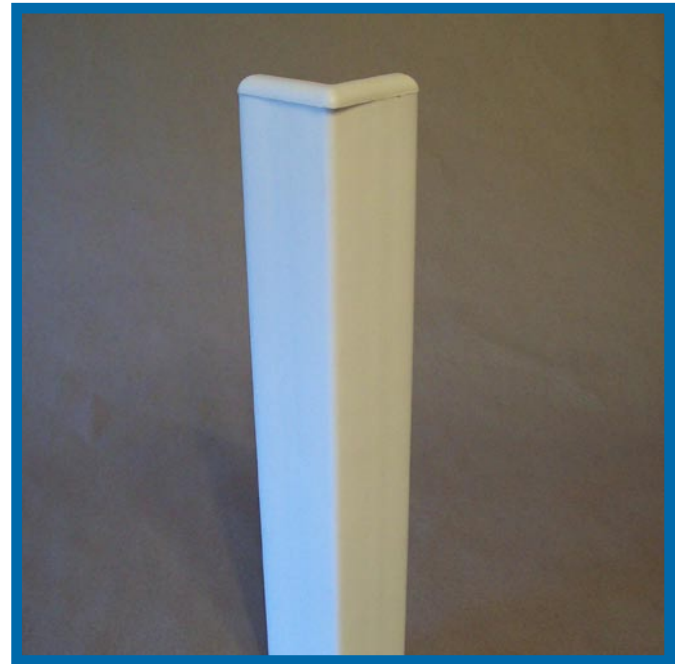

Surface Mount Corner Guard

Models CG2-S (shown), CG3-S, CG135-S

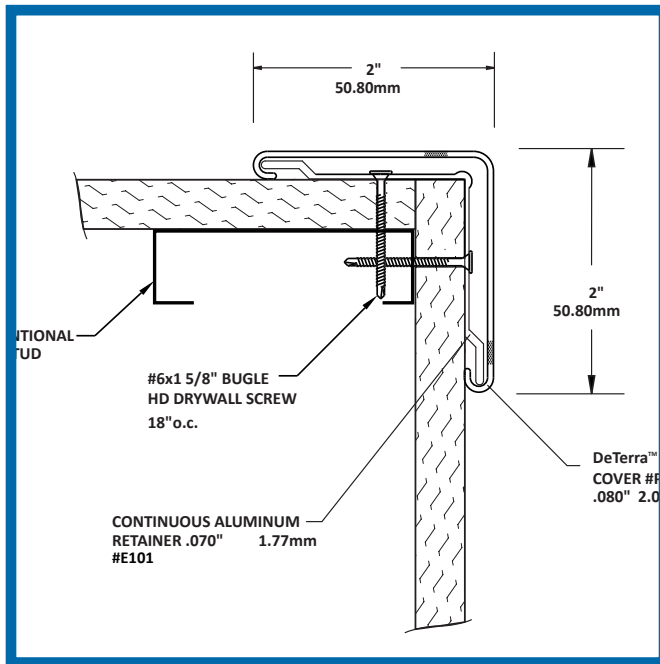

Surface mount corner guards protect corners from damage in both new construction and existing buildings. Continuous aluminum retainers secure snap-on covers made from deTerra™ biobased polymer covers and finished with injection-molded endcaps. Surface mount corner guards are available in standard 4'0 (1219 mm), 8'0 (2438 mm) and any custom length up to 12'0 (3658 mm)

DeTerra™ biobased polymer is made from 90% rapidly renewable materials that are grown, harvested and processed within 500 miles of our plant. It is free from persistent bioaccumulative toxins (PBTs) and is the only polymer wall protection that is petroleum-free. It is Class 1 fire-rated and outperforms PVC, ABS and PETG in most mechanical performance tests applicable to wall protection.

About Alpar Architectural Products

Alpar Architectural is a manufacturer of wall protection for use in healthcare, commercial and institutional buildings. All of our products are PVC-free and made from recycled and rapidly renewable materials, including deTerra™ biobased polymer, aluminum and stainless steel. Call for a catalog or visit our website to see our full line of handrails, crash rails, corner guards and sheet wall protection.

Alpar Architectural Products LLC
877-721-0156
612-721-0156
Fax 612-395-9183
info@alpararch.com
www.alpararch.com

© Copyright 2010 Alpar Architectural Products, LLC.
DeTerra is a trademark of Interfacial Solutions IP, LLC.